

ŠKOPAC RAVNI(A) INOX AISI 316

607

DEE SHACKLE STAINLESS STEEL AISI 316

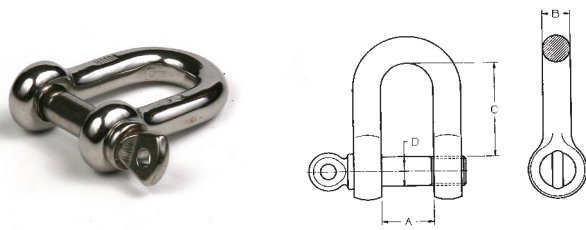

Šifra artikla	Promjer D mm	A mm	C mm	Nosivost Kg
607004	4	4	16	185
607005	5	5	20	300
607006	6	6	26	450
607008	8	8	32	750
607010	10	10	45	1450
607012	12	12	48	1800
607014	14	14	63	2800
607016	16	16	64	3300
607020	20	20	76	4000
607022	22	22	96	5000
607025	25	25	100	5500
607028	28	28	112	6000
607032	32	32	128	8500

ŠKOPAC OMEGA(Ω) INOX AISI 316

608

BOW SHACKLE STAINLESS STEEL AISI 316

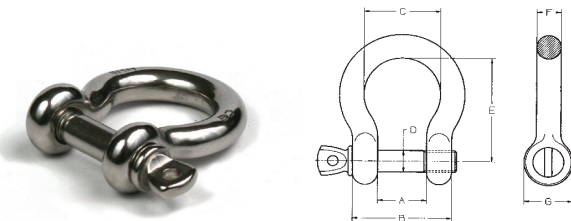

Šifra artikla	D mm	A mm	D mm	C mm	E mm	Nosivost Kg
608004	4	8	4	14	16	185
608005	5	10	5	17	20	300
608006	6	14	6	21	24	450
608008	8	16	8	28	32	750
608010	10	20	10	34	40	1450
608012	12	26	12	42	48	1800
608014	14	28	14	54	56	3000
608016	16	32	16	64	64	3300
608020	20	42	20	70	76	5100
608022	22	44	22	88	88	6000

ŠKOPAC RAVNI SA OSIGURAČEM INOX AISI 316

609

BOW SHACKLE STAINLESS STEEL AISI 316



Šifra artikla	Promjer B mm	A mm	C mm	D mm	Nosivost Kg
609006	6	4,8	9,7	19	330
609008	8	6,4	12	22	500
609010	10	8	13,5	26	750
609012	12	9,5	17	32	1000
609016	16	12,7	21	41	2000
609020	20	16	27	51	3000
609022	22	19	32	60	4000
609025	25	22	36	71	5000

ŠKOPAC OMEGA SA OSIGURAČEM INOX AISI 316

610

BOW SHACKLE WITH SAFETY RING STAINLESS STEEL AISI 316

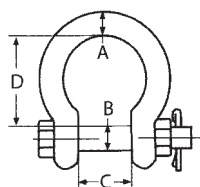

Šifra artikla	Promjer B mm	A mm	C mm	D mm	Nosivost Kg
610006	6	4,8	9,7	22	330
610008	8	6,4	12	29	500
610010	10	8	13,5	31	750
610012	12	9,5	17	36	1000
610016	16	12,7	21	48	2000
610020	20	16	27	60	3000
610022	22	19	32	71	4000
310025	25	22	36	84	5000

ŠKOPAC ŠIROKI INOX AISI 316

611

DEE SHACKLE WIDE SHAPE STAINLESS STEEL AISI 316

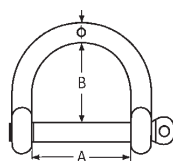

Šifra artikla	Promjer Ø mm	A mm	B mm	Nosivost Kg
611005	5	24	20	750
611006	6	25	33	1350
611008	8	26	31	2500
611010	10	41	55	3350
611012	12	50	66	4000

ŠKOPAC RAVNI SA VIJKOM INOX AISI 316

612

TWISTED SHACKLE STAINLESS STEEL AISI 316

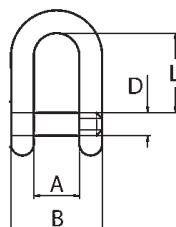

Šifra artikla	D mm	A mm	B mm	L mm	Nosivost Kg
612006	6	12	20	21	450
612008	8	16	32	28	750
612010	10	20	40	35	1450
612012	12	24	48	42	1800

ŠKOPAC OMEGA SA VIJKOM INOX AISI 316

613

LONG SHACKLE STAINLESS STEEL AISI 316

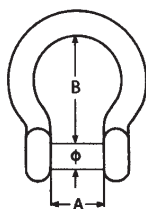

Šifra artikla	Promjer Ø mm	A mm	B mm	Nosivost Kg
612005	5	11	23	1200
612006	6	12	27	1700
612008	8	16	36	2500
612010	10	21	44	4300
612012	12	25	52	6200
612016	16	31	74	7000

ŠKOPAC IZDUŽENI INOX AISI 316

614 LONG SHACKLE STAINLESS STEEL AISI 316

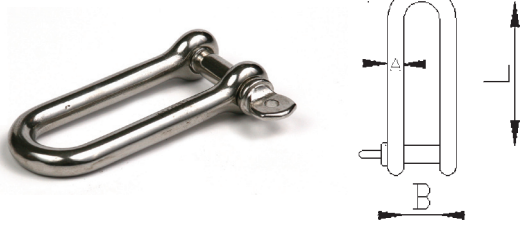

Šifra artikla	Promjer D mm	A mm	B mm	L mm	Nosivost Kg
614004	5	5	10	40	250
614005	6	6	12	48	350
614006	8	8	16	64	800
614010	10	10	20	80	1200
614012	12	12	24	96	1650

ŠKOPAC UVIJENI INOX AISI 316

615 TWISTED SHACKLE STAINLESS STEEL AISI 316



Šifra artikla	Promjer D mm	A mm	B mm	L mm	Nosivost Kg
615004	5	5	10	30	300
615005	6	6	12	36	400
615006	8	8	16	48	750
615010	10	10	20	60	1250
615012	12	12	24	72	1650

ŠKOPAC TANKI INOX AISI 316

616 FLAT SHACKLES SHORT TYPE STAINLESS STEEL AISI 316



Šifra artikla	Promjer D mm	A mm	L mm	H mm	Nosivost Kg
616004	4	10	17	23	200
616005	5	12	20	28	250
616006	6	16	24	33	500

ŠKOPAC TANKI DUGI INOX AISI 316

617 FLAT SHACKLES LONG TYPE STAINLESS STEEL AISI 316

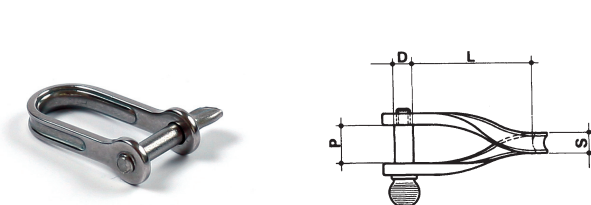

Šifra artikla	Promjer D mm	A mm	L mm	H mm	Nosivost Kg
616004	4	12	26	33	200
616005	5	16	27	35	250
616006	6	17	29	40	500

ŠKOPAC TANKI UVIJENI DUGI INOX AISI 316

618

FLAT AND TWISTED SHACKLES STAINLESS STEEL AISI 316

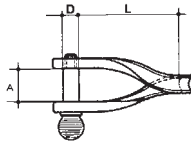

Šifra artikla	Promjer D mm	P mm	L mm	S mm	Nosivost kg
618004	4	11	22	5	200
618005	5	12	37	6	350

S KUKA

619

FLAT AND TWISTED SHACKLES STAINLESS STEEL AISI 316

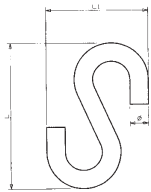

Šifra artikla	Promjer D mm	L mm	L1 mm
619004	4	38,5	21,5
619005	5	46	26,5
619006	6	52,5	31,5
619007	7	61	36
619008	8	64	44

BRZA SPOJNICA LANCA INOX AISI 316

620

QUICK LINKS STAINLESS STEEL AISI 316

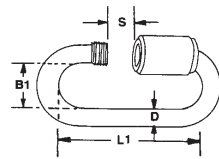

Šifra artikla	D mm	L1 mm	B1 mm	S mm
6200035	3,5	29	10	4,5
620004	4	32	12	5,5
620005	5	39	13	6,5
620006	6	45	14	7,5
620007	7	52	16	8,5
620008	8	58	18	9,5
620009	9	62	20	11
620010	10	69	22	12
620012	12	81	24	14,5

SPOJNICA LANACA KALIBRIRANA INOX AISI 316

621

REPLACEMENT LINK FOR CALIBRATED CHAIN STAINLESS STEEL AISI 316

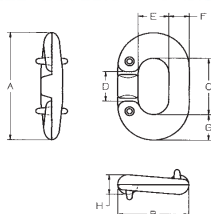

Šifra artikla	D mm	A mm	B mm	C mm	D mm	E mm	F mm	G mm	H mm	Prekidno opterećenje kg
621006	6	38	26	22	10	10	8	8	7	2100
621008	8	45	30	25	13	12	9	10	9	3000
621010	10	54	35	28	14	13	11	13	11	4600